

PHC

Injection Device
Technologies

PC-2A

Autoinjector with automated needle shield

Emergency, intramuscular self-injection system.

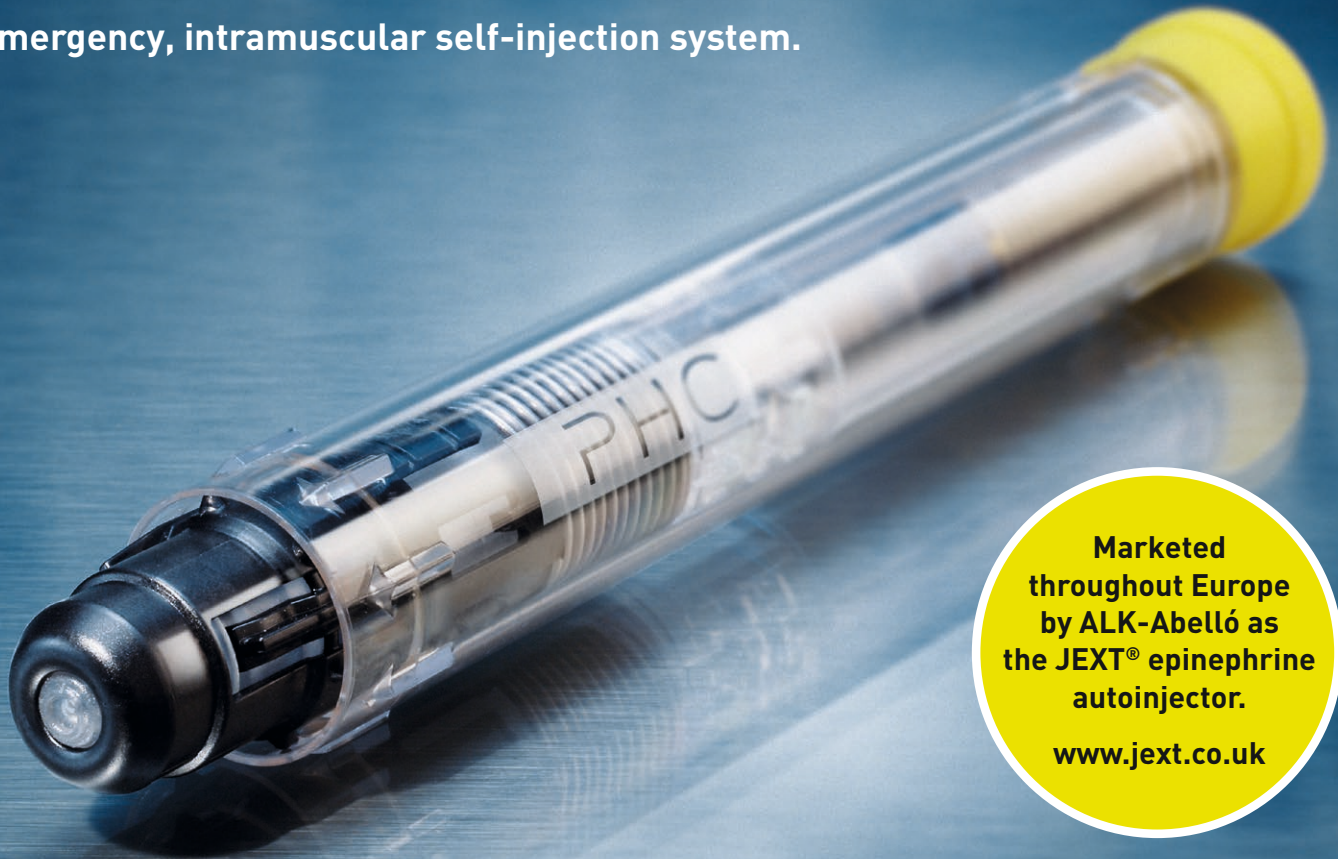

Marketed
throughout Europe
by ALK-Abelló as
the JEXT® epinephrine
autoinjector.

www.jext.co.uk

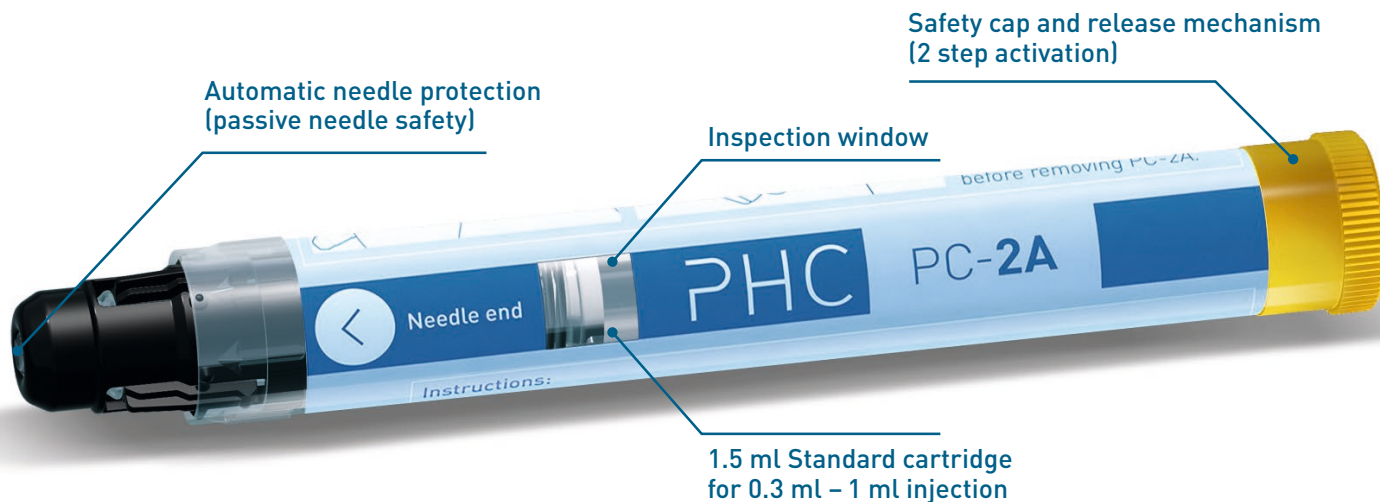

Simple, fast 2-step operating sequence:

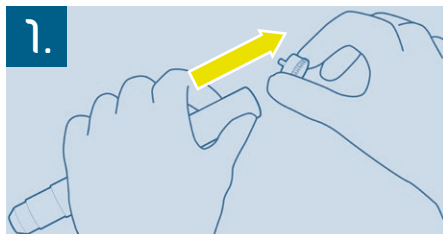

1. Remove PC-2A from protective pouch and pull off yellow safety cap.

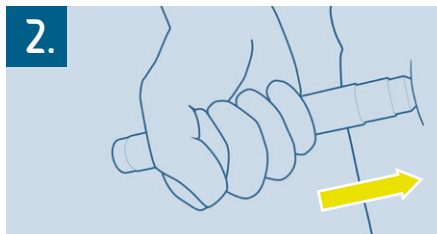

2. Push PC-2A firmly against the injection site to initiate the injection and deliver the medication. Hold in position for recommended time before removing PC-2A.

Technical Data*:

General:	
Overall length	155 mm
Max. diameter	22 mm
Weight	45 g
Medication:	
Filling volume	up to 1.4 ml
Injection volume	0.3 – 1 ml
Needle:	
Exposed needle length	up to 16 mm
Needle Gauge	up to 22 G
Needle shield	passive

* adaptations of device components possible

Please contact:

Pharma Consult GmbH, Divischgasse 4, A-1210 Vienna, Austria, T +43 1 291 07 664, www.phc-technologies.com